

Zubehör: Bride für Ventilhals
Accessoire: Brides pour le col de vanne
Optional extras: Clamp for the valve throat
Accessorio: Staffa per il collo della valvola
Accesorio: Abrazadera para cuello de válvula
Tillbehör: Montagesats för ventilhals
Toebehoren: Aansluiting voor regelklephals

Montagevorschrift
Instructions de montage
Fitting instructions
Istruzioni di montaggio
Instrucciones de montaje
Monteringsanvisning
Montagevoorschrift

AVF 234S F ...
 AVM 234S F ...
 AVN 224S F ...

Installationsanweisung für die Fachkraft / Monteur
 Notice d'installation pour le spécialiste / monteur
 Guidelines for the technician / fitter
 Informazioni per il personale specializzato di montaggio
 Instrucciones para el especialista del ramo / montador
 Installatietip voor de vakman / monteur
 Installationsinstruktion för installatör / montör

Für den Einsatz in üblicher Umgebung
 Pour usage dans un environnement normal
 For use in normal environments
 Per impiego in ambiente usuale
 Para el uso en ambiente normal
 För användning i normal miljö
 Voor toepassing in normale omgeving

1

0372338...	L1 (mm)	a (mm)	b (mm)	c	L2 (mm)	L3 (mm)	A	B	C	D	E	F
...001	129	38	38	M10	40	20	2x	1x	1x	1x	2x	2x
...002	206	60	60	M16	60	40	2x	1x	1x	1x	2x	2x
...003	-	44	44	-	-	-	-	1x	1x	-	-	-
...004	129	44	44	-	-	20	2x	1x	1x	-	-	2x

B10538a

2

0372338...	...001	...002	...003	...004
	1x s14 1x s17	1x s14 1x s19 1x s24	-	1x s14
	1x s6	1x s6	1x s6	1x s6
	1x	1x	-	-

B10539a

3

0372338 001
... 002
... 003
... 004

B10535

4

0372338 001
 ... 002
 ... 003
 ... 004

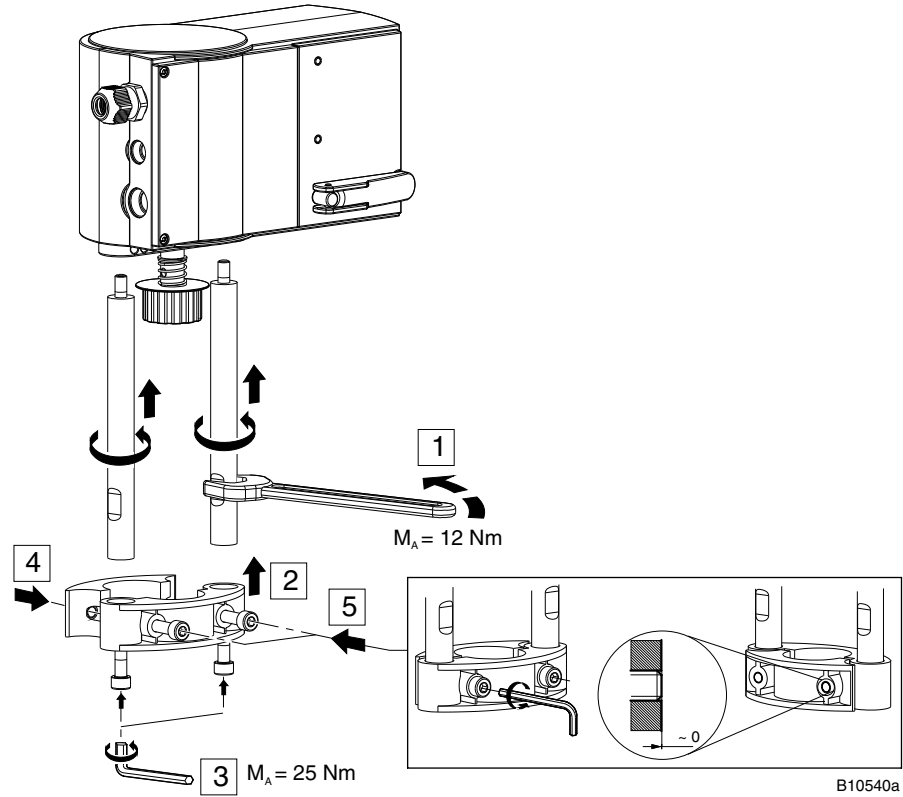

5

0372338 001
 ... 002

V6 . / B6 .
 DN15...150
 VXD/VXE
 BXD/BXE
 DN65...150

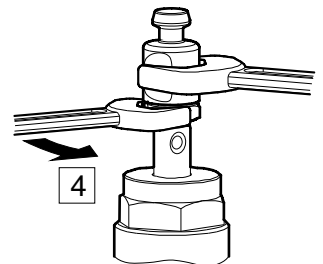
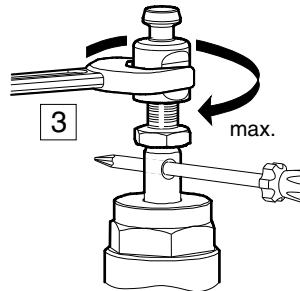
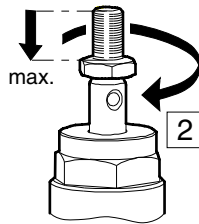
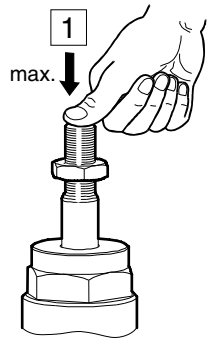

DN15...50 → M10 → $M_A = 15 \text{ Nm}$
 DN65...150 → M16 → $M_A = 50 \text{ Nm}$

VXD/VXE
 BXD/BXE
 DN15...50

0378263 001

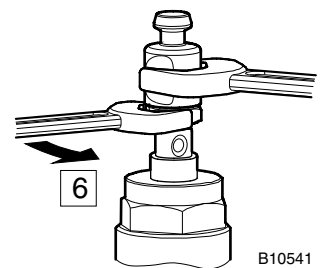
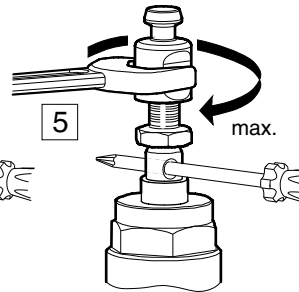
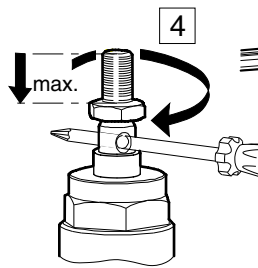
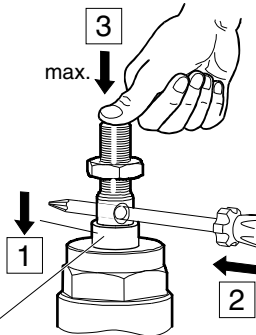

DN15...50 → M10 → $M_A = 15 \text{ Nm}$
 DN65...150 → M16 → $M_A = 50 \text{ Nm}$

B10541